



QUICKSTER[®] SOCCER TRAINER

GETTING STARTED



Thank you for your purchase. SKLZ prepares athletes to be ready for their sport and our team is happy to help you with product or program questions. Reach us by email at customerservice@SKLZ.com or by phone at **877-225-7275 x128**.

BEFORE YOU BEGIN:

- Read all the setup and usage instructions carefully before using. If the setup and/or usage instructions are not followed correctly, it could result in injury or damage to the product.
- Adult setup is recommended.
- Athletes under 18 years of age should use only under adult supervision.
- Make sure you have all of the Quickster Soccer Trainer components. Please contact SKLZ customer service toll free at 1-877-225-7275 x128 if you are missing anything.

⚠️WARNING:

- Quickster Soccer Trainer is under tension when set up. Please take the utmost care when releasing the tension during disassembly. Failure to do so may result in injury.
- Do not climb or hang on the Quickster Soccer Trainer.
- When in use, make sure the Quickster Soccer Trainer is set up in a clear area to avoid injury and/or damage to property.
- To avoid pinching, use caution when connecting the push-button tubing.

CARE INSTRUCTIONS:

- When finished using, store the Quickster Soccer Trainer after use. Do not leave outdoors.
- Keep away from fire and heat sources.
- Make sure Quickster Soccer Trainer is free of debris and moisture before storing.

PATENTED: US 8,246,496; 8,579,737; CHINA 101678299; EU EP2146786 B1. ADDITIONAL US & WORLDWIDE PATENTS PENDING

IDEA SUBMISSION

If you have an idea for a new and innovative sports training product, visit SKLZ.com to submit your concept.

Some restrictions may apply.

1 YEAR LIMITED WARRANTY. This warranty does not cover damages resulting from accident, misuse, abuse or lost merchandise, and is only valid in the USA. Register your product at SKLZ.com to ensure warranty coverage, and get new product information and special deals from SKLZ. Questions? Email: customerservice@sklz.com or call toll free: **877-225-7275**

Made in China. ©2014 Pro Performance Sports, LLC. All rights reserved. Manufactured and distributed by SKLZ/Pro Performance Sports: 2081 Faraday Avenue, Carlsbad, CA 92008 U.S.A. SKLZ, SKLZ Pro Grade, SKLZ Chrome and Sport-Brella are registered trademarks of Pro Performance Sports, LLC., its subsidiaries and affiliates. Product features, appearance, and specifications may be subject to change without notice. Unauthorized duplication is a violation of applicable local and international laws.

IN THE BOX



A STORAGE BAG

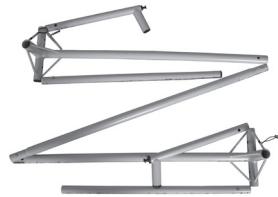

B FRAME



C TENSION-TITE™ POLES (4)



D REBOUNDER NET



E PASSING NET



F GROUND STAKES (4)

GETTING STARTED

1

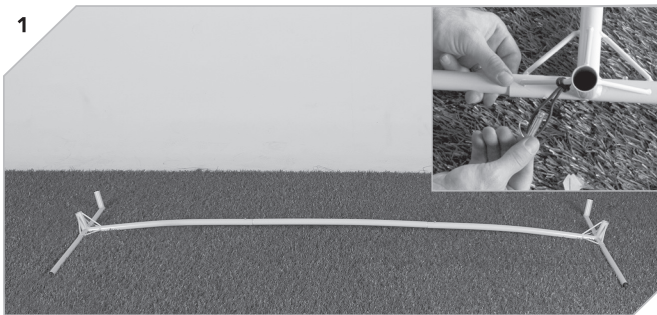

Carefully remove net from storage bag (A). Frame components are connected with elastic to simplify assembly. Assemble base frame (B) flat on ground and snap sections together. The passing net supports require the insertion of a small attached pin (see inset illustration).

2



Insert the longer Tension-Tite™ poles (C) into middle sockets on base frame (B).

3

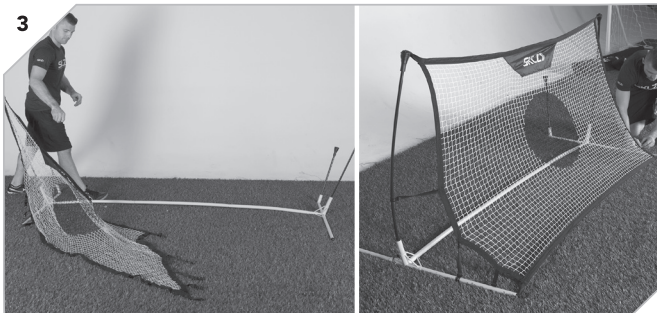

Attach rebounder net (D) by inserting corner pins from net into the tops of the support poles, then the bottom loops. Snap all clips in place to secure it to the rest of the frame.

4

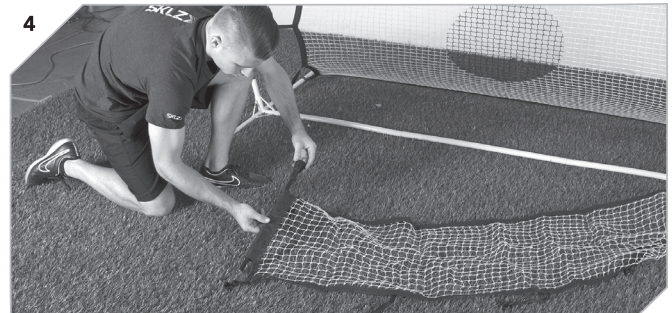

Insert the shorter support poles through the sleeves on the ends of the passing net (E).

5



Insert support poles into the base frame, stretching the net between. Finish attaching the net by snapping the clips along its edges to the base frame (B).

6

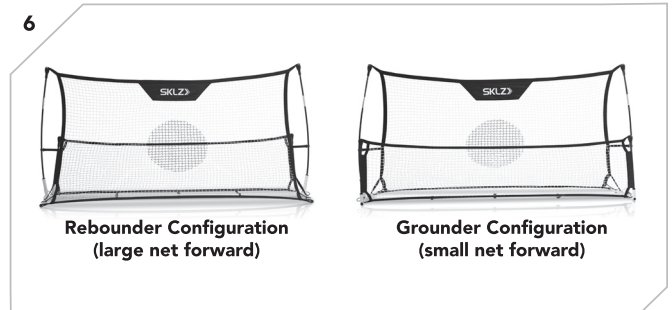

Use ground stakes (F) to secure the net in place for use.