

# CABLE GLAND INSTRUCTIONS



## FOR CABLE GLAND PART #

CG20P-G	CG30P-G	CGM17P-G
CG20A-B	CG30A-B	CGM17A-B
CG20-SS	CG30-SS	CGM17-SS

## TOOLS NEEDED

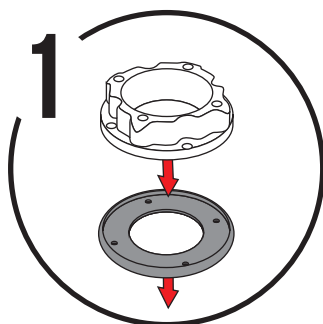
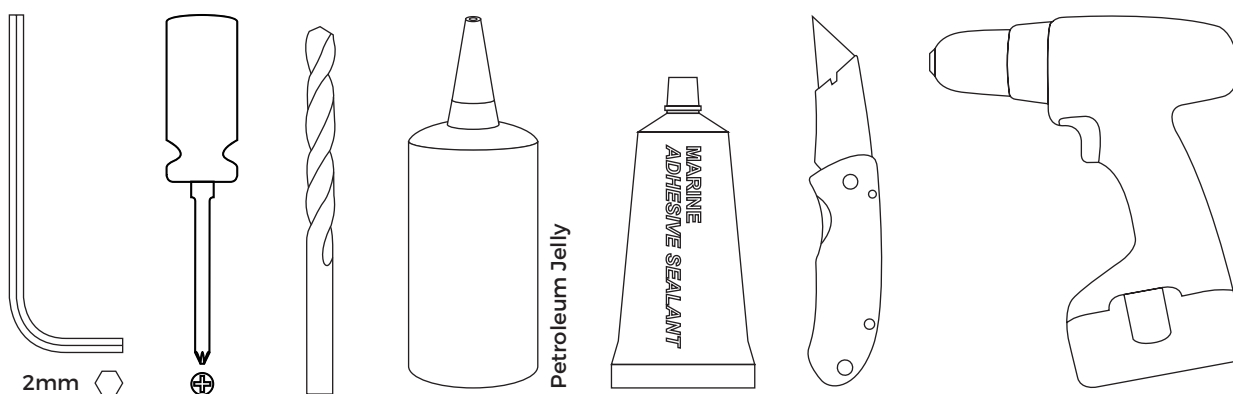

1 Place the plastic base onto the rubber base gasket. Be sure to line up the four screw holes.

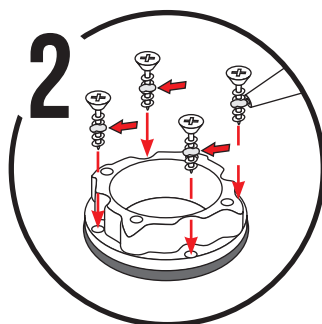

2 Apply some marine sealant to the threads of the screws. Screw in the four screws using a philips head screw driver.

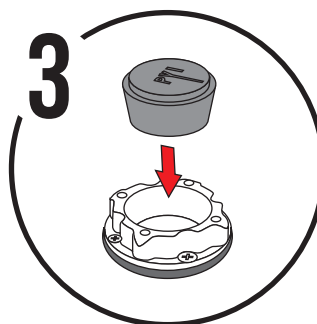

3 Insert the rubber gromet into the plastic base.

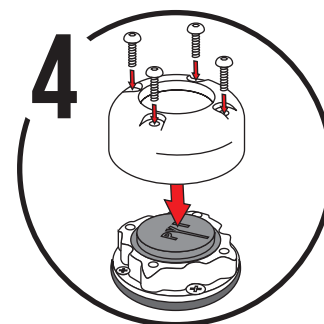

4 Line up the Cable Gland cover with the four holes in the plastic base and screw the bolts in with a allen wrench.

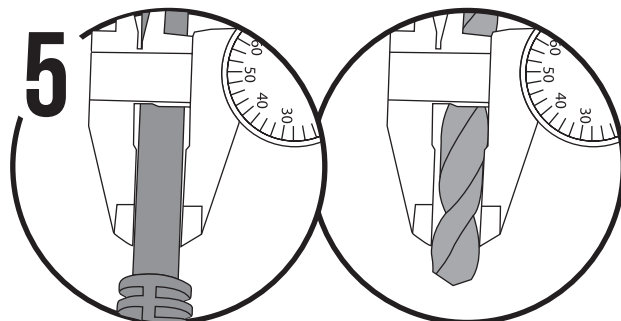

5 Measure your cable diameter and select the appropriate drill bit.

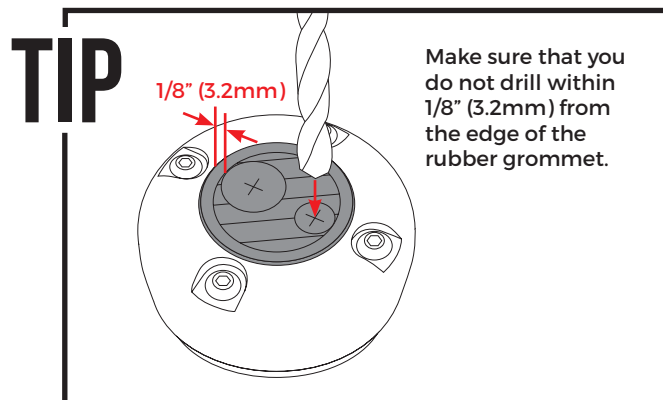

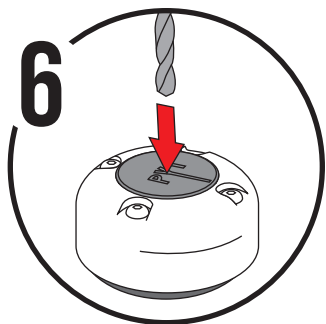

Drill the rubber grommet using the appropriate size drill bit.

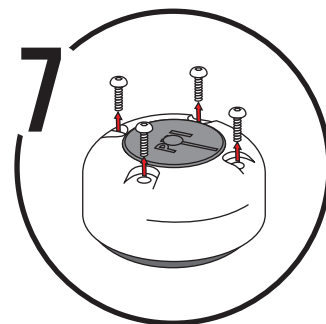

Remove the four screws using a allen wrench.

**TIP** For a cleaner cut try this method for drilling your Cable Gland.

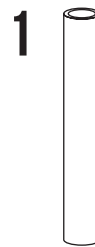

Get a tube with a proper diameter for your cables.

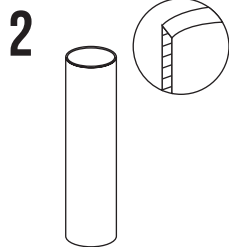

File the end of the tube so that there's a sharp edge.

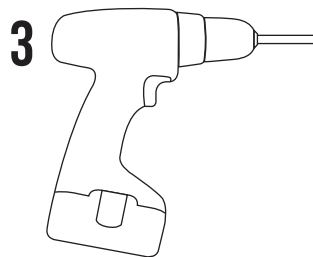

Put the sharpened tube into a drill.

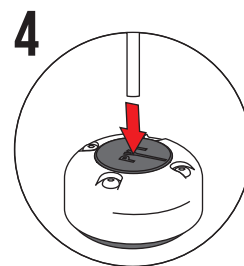

Apply small amount of soapy water to the tube and drill the Cable Gland.

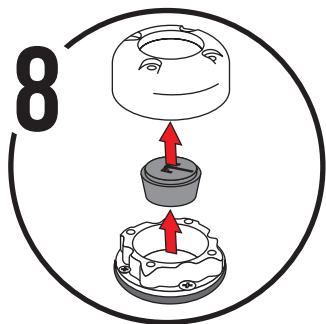

Remove the Cable Gland cover and rubber grommet.

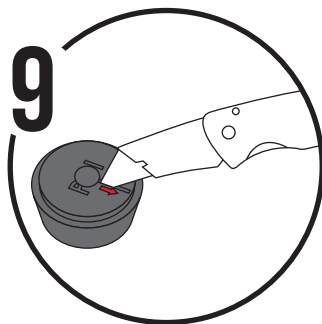

Using a sharp knife cut the rubber grommet from the cable hole outward.

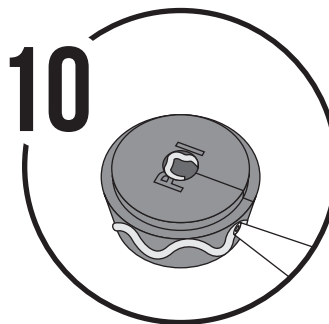

Apply a petroleum jelly such as Vaseline into the center cable hole and along the outer edge of the rubber grommet.

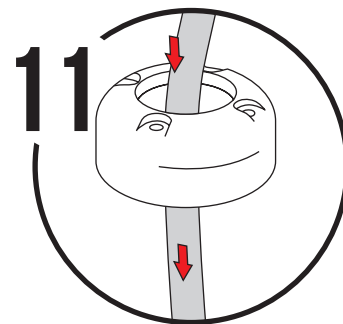

Slide the Cable Gland cover over the electronic cable.

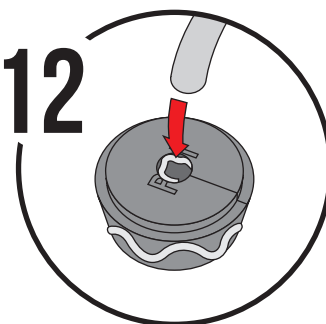

Wrap the rubber grommet around the electronic cable.

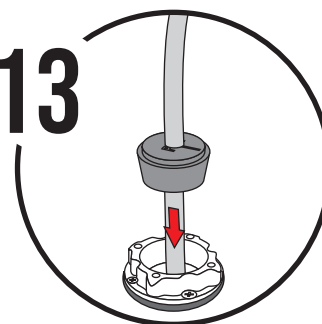

Insert the electronic cable and rubber grommet into the plastic base.

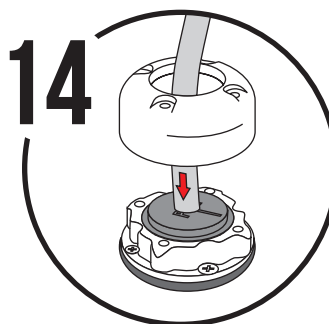

Slide the Cable Gland cover onto the plastic base making sure that all four bolt holes line up.

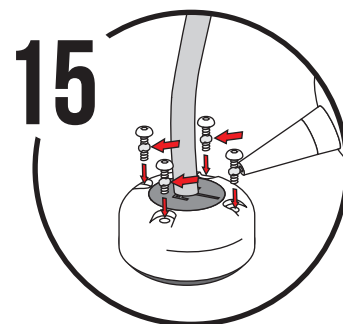

Apply marine sealant to the threads of the four bolts. Using a allen wrench fasten the four bolts down tightly.