



USER GUIDELINE

Thank you for choosing MOON light!

*For using this product safely and conveniently and keeping it well-preserved, please read this manual carefully before using. Please save this manual for future reference.

*Due to the improvement of the product, the product you bought may not be exactly in accordance with the introduction of this manual. We apologize for that.

SPECIFICATION

- *1 pc (16 chips) COB high brightness white LED
- *CNC Aluminium heat sink casing
- *Auto safe mode
- *Mode memory function
- *Rechargeable lithium polymer battery (3.7V 300 mAh)
- *7 modes: Mode1 / Mode2 / Mode3 / FL1 / FL2 / FL3 / DAY FLASH (DOUBLE BLAST)
- *Quick release universal bracket RB-22 (fits all round bars and AERO style bars)
- *Low battery, charging and fully charged indicator
- *Automatic fully charged cut-off system
- *Side visibility
- *Water resistant (IPX 4)

CONTENTS INCLUDED



Contents:

- *COMET-X (Front)
- *RB-22 (Universal bracket)
- *2 O-rings for mounting: RS-G (fits 20-35mm diameters) RS-H (fits 35-52mm diameters)
- *BK-21 (Belt clip)
- *USB-WP (Water resistant USB cable)

Optional accessories:

- *RB-23 (Helmet bracket)
- *USB-RM-350 (USB remote control 350mL)

LIGHT OPERATION

Low battery status

⚡ * Steady blue

Auto safe mode

⚡ * Flashing blue

Power button

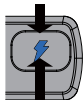

Indicators

1. Double click the power button to toggle between the steady and flashing modes. (With mode memory, the light will resume previous mode upon next usage.)

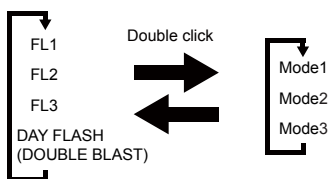

2. Press and hold the power button about 1 second to switch off. (With mode memory, the light will resume previous mode upon next usage.)

HOW TO MOUNT THE LIGHT

1. Choose the strap to fit in the bar.
2. Make sure the strap is clicked in place of the hook.
3. Hold the light on the handle bar/seat post.
4. Wrapping rubber strap around bar and stretching strap around hook to secure.
5. Slide the light forward onto bracket until it clicks into place.
6. Press down release lever to remove.

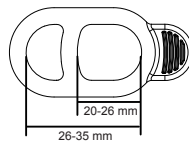

RS-G

20-35 mm

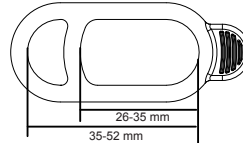

RS-H

35-52 mm

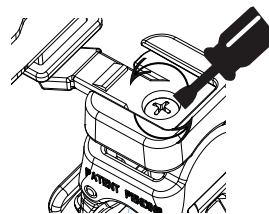
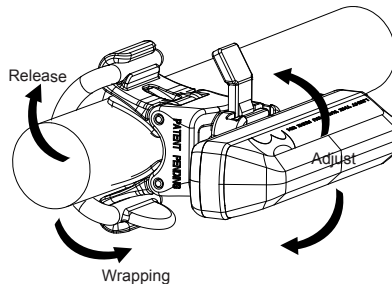
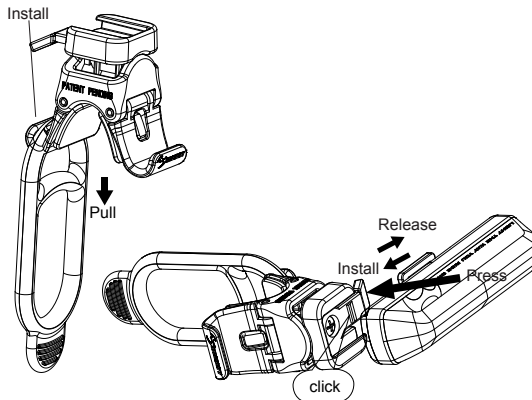

7. Adjust the horizontal beam angle when mounted on the handle bar loosen the screw knob and spin the light left to right for your preferred angle, then tighten the screw knob to secure the light in place.

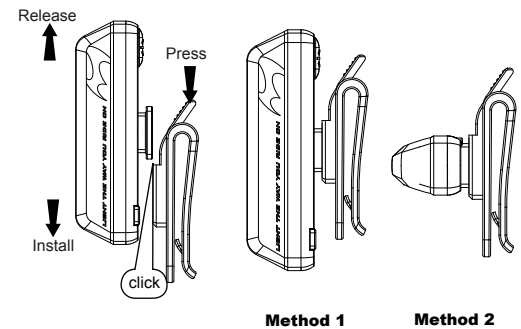

Method 1

Method 2

1. Slide tail light forward onto belt clip until it clicks into place.
2. Press down release lever to remove.

BEAM ADJUSTMENT

To adjust the horizontal beam, spin the headlight left to right for your best side to side beam angle. To adjust the vertical beam angle, loosen the mounting and rotate the light up and down to your best vertical beam angle, then tighten the mounting.

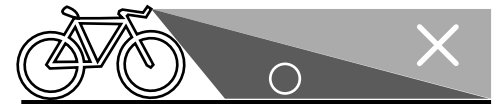

The beam is widely dispersed, besides its high brightness. To prevent from blinding the oncoming vehicles on the public roads, you'd better adjust the angle downward.

AUTO SAFE MODE

1. When the signal "⚡" turns on, it means the battery is low. You should charge your light.



Steady-Blue

2. When the signal "⚡" flashes, it means that is in very low power stage, then the safe mode will be on and cannot be changing mode accordingly. The light may have an hour left for usage. (Depending on which mode the light was on before entering safe mode, it would affect the run time of safe mode before battery is completely drained.)



Flashing-Blue

HOW TO CHARGE BATTERY

Attention: If you do not use the battery for a long time, be sure to fully recharge every 3 months. Please store the battery in a cool and dry place. Recharge battery after each long usage.

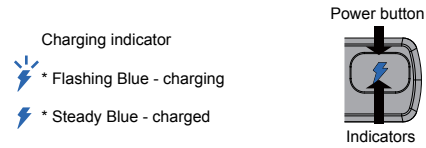

CAUTION

- *Do not charge over 5V the battery will result in damage.
- *Keep away from flammable objects while charging as this may lead to fire or battery explosion.
- *Do not smoke while charging as the battery may release hydrogen gas. Always charge your battery in a well-ventilated space.
- *Never connect or disconnect the plug or cord with wet hands whilst charging. Do not connect or disconnect the plug or cord when they are wet, it may lead to electric shock.

1. Find the charging place at the back of the light.
2. Lift the rubber cover and you'll see the charging port.
3. Plug the USB cable to your computer USB port.
4. Plug the charger cable to the light charger port.
5. The charging indicator shows slow flashing blue when the light is charging, after fully charged it changes to steady.

6. It is normal that the battery may get high temperatures during charging (up to 104°F/40°C), as the chemical in battery is in reaction. If the battery is not drained completely before charging, it may also get warm.

7. Several factors can influence the battery's durability: type of cell strain, the maintenance routine, the temperature and number of charges etc.
Normally speaking, the higher the battery capacity, the longer the burn time.

8. The battery capacity may become ineffective about 80% of its value after 300-500 charge/discharge cycles. The battery may have 3 years life span under good care.

9. The battery voltage and capacity decrease apparently at low temperatures, especially near or below ice point. The capacity decreases 5%-10% at freezing (burn time decreases 50%). At -20°C, the capacity decreases 30% (burn time decreases 70%). The battery performance will return normal when the temperate gets up to 70°F/20°C.
The battery will lose around 1% of its capacity per day when you store the battery at normal room temperature. Battery temperate should never exceed 104°F/40°C, it will lose about 5% of its capacity per day.

10. If you do not use the battery for a long time, be sure to fully recharge every 3 months. Please store the battery in a cool and dry place.

SIMPLE PROBLEMS ANALYSIS AND SOLUTION

1. Problem: The light is not on

Solution: Check if the battery still has power
Check if the power button is pressed hard

COMET-X (Front) RUN TIME

Mode	Lumens	Run Time	Recharge time
Mode1	20	5:30	
Mode2	40	2:40	
Mode3	60	1:30	
Double click		(Auto safe) around 1 hr	2 hrs
FL1	25	18:30	
FL2	60	7:30	
FL3	60	12:00	
DAY FLASH (DOUBLE BLAST)	120	23:00	

Weight: 25 g

* The time of recharging depends on which method (wall charger or computer) is being used.

