

AFTER-SALES SERVICE WARRANTY CARD

PRODUCT INSTRUCTION OF LIVALL PHONE HOLDER

After-Sales Information:
Thank you for purchasing LIVALL product, please read the following instructions for better service.

- 1.This product can be replaced within three months after the date of purchase, and come with a one year warranty.
- 2.Damages caused by the following reasons are not included in the scope of free warranty:
•Exceeding the specified warranty period;
•Damages caused by failure to follow the operating instructions;
•Damages caused by unauthorized disassemble or maintenance by users or other man-made damages.
- 3.This warranty card is the important certificate for the warranty service provided to the end user, please keep it well. The card should be taken along with the product to the manufacturer when the maintenance is required.
- 4.Our company reserves the rights to modification and explanation for above terms and conditions.
For more information, please visit www.livall.com.

User Name: _____
Tel.: _____
ID No.: _____
Home Address: _____
Seller: _____
Purchase Date: _____
Maintenance Record: _____

Note: This form should be completed in real details; otherwise, it would be invalid.

Thanks for choosing LIVALL phone holder. Please read the instructions carefully before use to ensure safe and satisfactory operation of this product. Please retain these instructions for further reference.

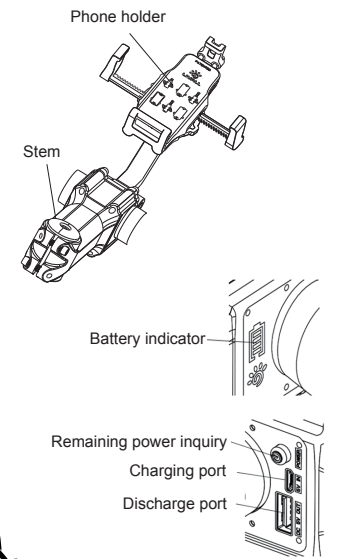

I.INSTALL S2
Remove the original stem and replace it with LIVALL S2 holder.

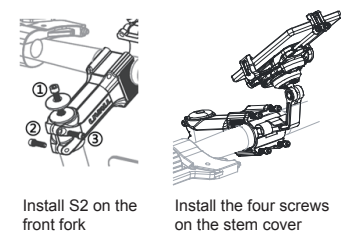
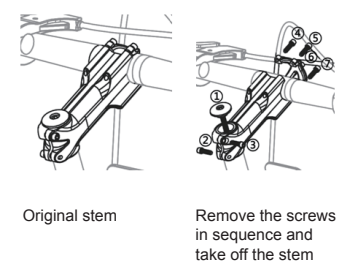

II.INSTALL H2
Remove the two screws on the top of the original stem and install LIVALL H2 phone holder.

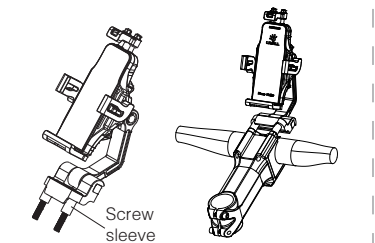

III.ADJUST THE ANGLE OF THE PHONE

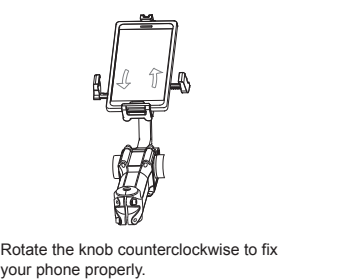
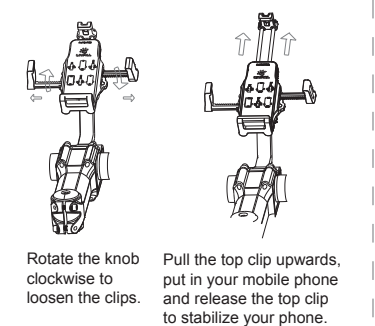



IV.CHARGE THE PHONE WITH S2

Connect the device to be charged to the USB port  by a USB cable. During discharging, the remaining power would be displayed.

V.CHARGE S2

Use a Micro USB cable to connect the  port to a USB charger with safety approvals such as CCC or UL. The charging power would be on display during charging.

VI.CHECK S2 POWER

Press the power button  to check the remaining power, which is displayed by the icon .

VII.PRODUCT SPECIFICATIONS

- Applicable phone size: 4-6 inches
- Rotating angle of phone holder: 360°
- Vertical turning angle of phone holder: >200°
- Bikes applicable to H2: using M5 screws on the stem; distance between two screws: 14-34 mm.
- The following parameters apply to S2: Bikes applicable to S2: diameter of the central handlebar diameter: 31.8 mm; diameter of front fork stem: 28.6 mm.
- Battery capacity: 3.7V/5000mAH
- Charging port: Micro USB 5V/1A
- Charging duration: around 7h
- Output port: USB A, 5V/2A output
- Button: power checking
- Lighting indicator: four level power indication
- Stem length: 120mm
- Product size: 180*116*125mm

VIII.PRECAUTIONS

- 1.If the product is being used for the first time or if the product has not been used for a prolonged period, the battery may self-discharge slowly over time. Generally, it takes five to six full charge and discharge cycles for the battery maximize the performance.
- 2.Use a charger with safety approvals such as CCC or UL to charge this product.
- 3.Rough handling can cause damage to the internal precision parts and structure of the product.
- 4.Properly store this product and relevant accessories and place them out of reach of children.
- 5.It is normal for the product to get warmer during charging.
- 6.Keep the product away from fire or other heat sources to avoid danger.
- 7.Avoid contact with metal objects to the charging port or discharge port; otherwise, short circuit may occur and cause damage to the product.
- 8.Changes or unauthorized repair of the product could cause the product failing in normal use and void the warranty.



Download the app

www.livall.com

LIVALL Phone Holder



Designed and Assembled in Shenzhen China

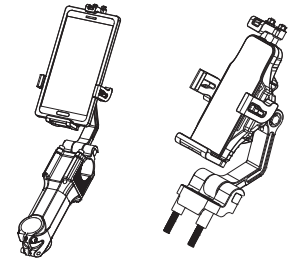

S2

H2

Phone Holder

售后须知:

感谢您购买LIVALL产品,为了更好的为您服务请仔细阅读以下说明

- 1、本产品自购买之日起三个月包换,一年保修。
- 2、下列原因引起的产品损坏,不在免费保修范围:
 - 超出规定的保修期限;
 - 不按说明书要求操作引起的损坏;
 - 用户私自拆卸、维修引起的损坏,其他人造成的损坏。
- 3、本保修卡为最终用户享受保修服务的重要凭证,请妥善保管,维修时需携带本卡与产品一起交于当地厂家进行维修。
- 4、本公司保留对以上条款的修改权和解释权。更多详情请见:www.livall.com

用户姓名: _____
电话: _____
证件号码: _____
家庭地址: _____
销售商: _____
购买日期: _____
维修记录: _____

注:此表格填写真实,未按要求填写者无效

感谢您使用Livall 手机支架,请仔细阅读本产品说明书,以确保安全和满意的操作,请将此说明书妥善保存,以便以后查阅。

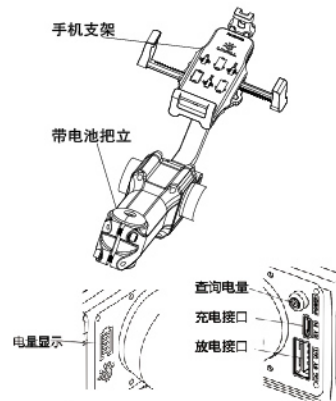

1、S2安装

将原单车把立拆下,换上LIVALL S2 支架

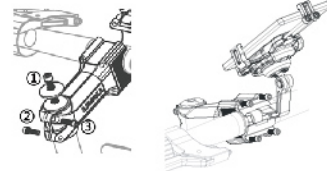
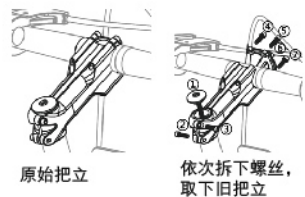

将S2安装在前叉上

安装把立盖4颗螺

2、H2安装

将原单车把立上方的2颗螺丝拆掉,换上LIVALL H2 支架

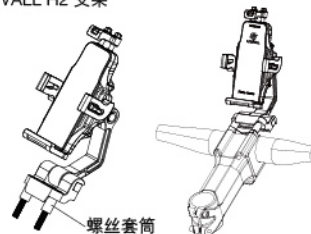

3、调整手机使用角度

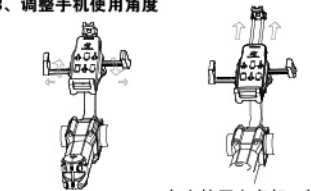

向上拉开上卡扣,放入手机,松开上卡扣,初步扣住手机。



逆时针旋转旋钮控制左右卡扣适当扣住手机。

4、S2给手机充电

将 USB 接口通过USB连接线连接需要充电的设备即可,在放电时同时会显示电池电量。

5、给S2充电

将 接口通过Micro USB 充电线连接到有标识CCC或UL标记的USB充电器上即可,充电时会显示充电电量。

6、S2查询电量

单按 Power 按钮,可以查询电量,通过 图标显示

7、产品规格

适用手机:4-6英寸
手机支架旋转角度:360度
手机支架仰角翻转角度:大于200度
H2适用于把立螺丝为M5,且两颗螺丝间距为14-34mm的自行车。
以下参数适用于S2:
S2适用车把中部直径为31.8mm前叉立管直径28.6mm的自行车。

电池容量:3.7V/5000mAh
充电接口:Micro USB 5V/1A
充电时间:7小时左右
输出接口:USB A型接口,5V/2A输出
按键:电量查询
电量指示:4级电量指示
把立长度:120mm
产品尺寸:180*116*125mm

8、注意事项

- 8.1 本产品初次使用或长期储存后再使用时,移动电源主机可能已自动逐渐放电,一般需要在5-6次完全充电和放电的周期后才能达到最佳性能。
- 8.2 请使用通过3C或UL充电器为本产品进行充电。
- 8.3 请勿扔掷 强烈摔打 震动货摇晃本产品,否则可能会破坏内部精密的零件和完好的结构。
- 8.4 请妥善保管本产品及相关配件,避免置于儿童容易触及的地方。
- 8.5 充电时,本产品会轻微发热,这是正常现象。
- 8.6 勿将移动电源主机接近火源或其他热源,以免产生危险。
- 8.7 避免让金属物品接触移动电源主机的充电和放电插口,否则会产生短路,损坏主机。
- 8.8 未经授权产品改动或自行修理可能会导致您无法正常使用本产品及保修失效。



Download the app

www.livall.com

LIVALL Phone Holder



Designed and Assembled in Shenzhen China

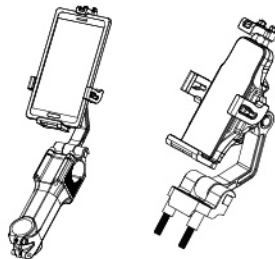

S2

H2

Phone Holder