



# SPINEL

Fully adjustable four buckles sit harness ideal for mountaineering and winter climbing.

## DESCRIPTION

Two buckles in a waist belt enable to center the harness, keeping the gear loops in an optimal position.

Belay loop 12 mm wide with strength 15 kN.

Abrasion resistance fabric at tie-in points for longer lifetime of the harness.

Patented 16 mm wide stainless steel Rock & Lock buckles on the leg loops enable fast adjustment.



Rear haul loop with a load capacity 30 kg.

2 slots with easier placement for additional carabiner PORTER.

Ergonomic braided gear loops are shaped to facilitate easy handling and to provide enough space for your climbing gear.

Unique, patented Rock&Lock buckle is made of stainless steel to increase corrosion resistance.

For both leg loops and waist belt the variable width webbing is used. On leg loops is going from 16 mm to 40 mm wide inside padding for maximum comfort.

## KEY FEATURES

- Ergonomic construction combines maximum comfort and low weight.

## STANDARDS

CE 1019  
EN 12277, type C

## FEATURES



## TECHNICAL DATA

**BMI**

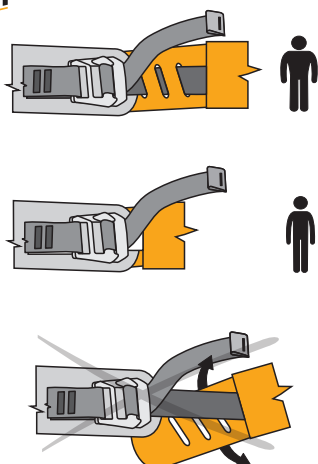

**Rock Lock**

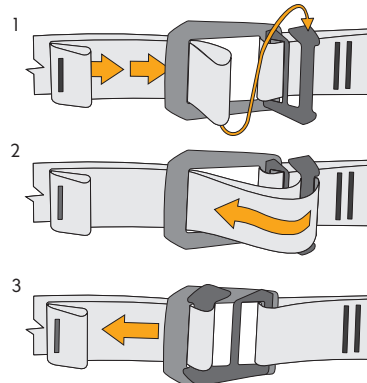

TECHNICAL DATA

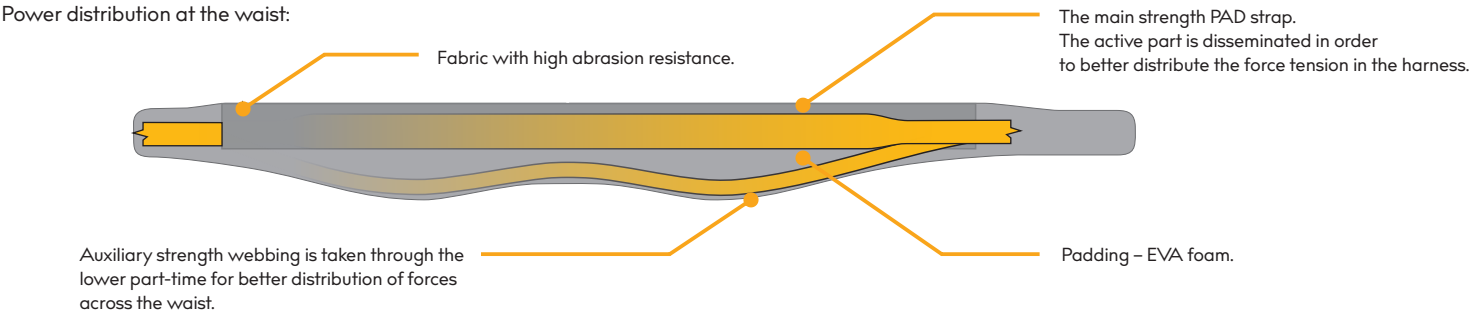

COMPARISON

SPINEL C5062 (old) vs. SPINEL C5074 (new)

- More durable reinforced tie-in points for longer lifetime of the harness.
- More durable and comfortable solution of slots for PORTER.
- 20 g lighter.
- New Rock&Lock buckles on leg loops are 16 mm wide. Variable webbing is still 40 mm wide inside padding for maximum comfort.



SPINEL C5062

OTHER VIEWS



MATERIALS

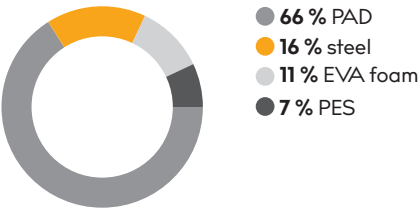

SIZE CHART



SIZE	XS	S	M	L	XL	XXL
A [cm]	65–80		75–90		85–100	
A [in]	25,5–31,5		29,5–35,5		33,5–39,5	
B [cm]	50–55		60–65		65–70	
B [in]	19,5–21,5		23,5–25,5		25,5–27,5	

MAINTENANCE

Product life is not strictly determined by the manufacturer. Depending on the condition of the product and the history of its use, it may be necessary to withdraw it from the service immediately. The maximum useful life from the date of manufacture including the storage is 15 years.



washing



drying



beware  
of salt



beware  
of UV



beware  
of chemicals



read  
instruction