

PEARL

All-round harness specially designed to fit female body with graceful design for women's climbing.

DESCRIPTION

Rear haul loop with a load capacity 30 kg.

Belay loop 12 mm wide with strength 15 kN.

Abrasion resistance fabric at tie-in points for longer lifetime of the harness.

Patented 16 mm wide stainless steel Rock & Lock buckles on the leg loops enable fast adjustment.



Specially shaped waist belt and longer belay loop to fit women's physique.

Ergonomic braided gear loops are shaped to facilitate easy handling and to provide enough space for your climbing gear.

Unique, patented Rock&Lock buckle is made of stainless steel to increase corrosion resistance.

For both leg loops and waist belt the variable width webbing is used. On leg loops is going from 16 mm to 40 mm wide inside padding for maximum comfort.

KEY FEATURES

- Ergonomic construction combines maximum comfort and low weight.

STANDARDS

CE 1019
EN 12277, type C

FEATURES



TECHNICAL DATA

BMI

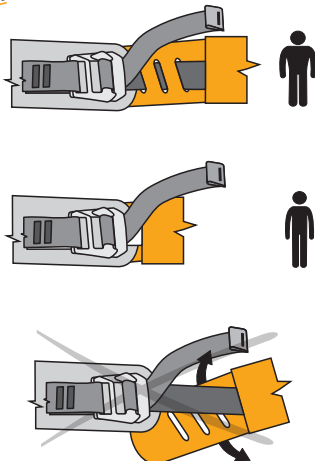

ROCK LOCK

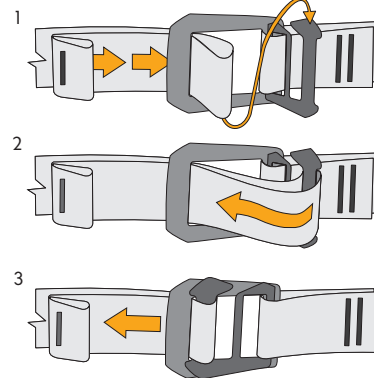

TECHNICAL DATA

Power distribution at the waist:

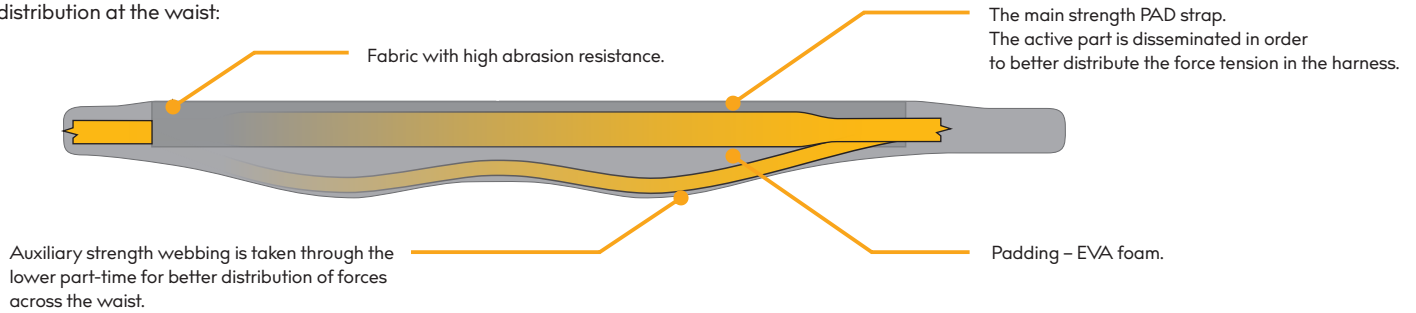

COMPARISON

PEARL C5061 (old) vs. PEARL C5072 (new)

- More durable reinforced tie-in points for longer lifetime of the harness.
- New Rock&Lock buckles on leg loops are 16 mm wide. Variable webbing is still 40 mm wide inside padding for maximum comfort.
- 15 g lighter.
- Rear haul loop with a load capacity 30 kg.



PEARL C5061

OTHER VIEWS



MATERIALS



- 66 % PAD
- 16 % steel
- 11 % EVA foam
- 7 % PES

SIZE CHART



SIZE	XS	S	M	L	XL
A [cm]	60-70	65-75	70-80	75-85	80-90
A [in]	21,5-25,5	25,5-29,5	27,5-31,5	29,5-33,5	31,5-35,5
B [cm]	45-50	50-55	55-60	60-65	60-70
B [in]	17,5-19,5	19,5-21,5	21,5-23,5	23,5-25,5	21,5-23,5

MAINTENANCE

Product life is not strictly determined by the manufacturer. Depending on the condition of the product and the history of its use, it may be necessary to withdraw it from the service immediately.

The maximum useful life from the date of manufacture including the storage is 15 years.



washing



drying



beware of salt



beware of UV



beware of chemicals



read instruction