

TECHNOLOGY

CORE TECHNOLOGY AND ACTIVE STRAP TECHNOLOGY

These fundamental technologies make Flow bindings an industry leader. Active Strap Technology automatically lifts up the footstraps when you open the reclining hibiack, and actively tightens them again to your personal position when you close the hibiack. This reduces friction and creates more room for your boots, so that getting in & out of your bindings is faster and easier than ever.

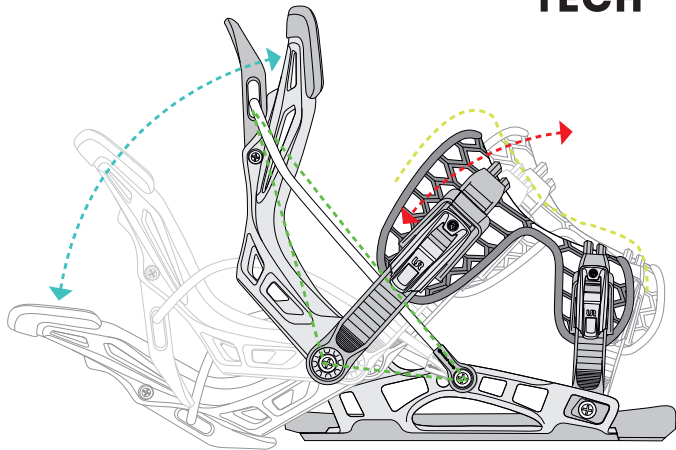

- RECLINING HIBACK**
The fully reclining hibiack is a pivotal part for the fastest easy-in easy-out binding system. When you open the reclining hibiack, a single system actively lifts up the strap, and this same system tightens the strap automatically when you close the hibiack.
- POWER-TRIANGLE**
The Free high-tensile steel cable creates a structural triangle between the hibiack and baseplate for optimum energy transfer and making quick, easy and efficient turns.
- POWER-STRAPS**
Flow PowerStraps are 3D-shaped and cover the critical mid-fore area, connecting the ankle and toe straps. The small is more control and better energy transfer. Also no need to overlighten, which benefits blood-circulation, and avoids pressure points and cold, cramped feet!
- ACTIVE STRAP**
When you open the hibiack, the footstrap gets actively pushed out of the way, so you can easily and conveniently get your foot in and out of the binding. With the same ease, the Power-Strap footstrap hugs your foot at the considered tightness you first set it at each time you close the hibiack.

ACTIVE STRAP TECH

BASEPLATES

All of Flow's rockered baseplates are engineered to transfer energy directly to the board without loss of efficiency or natural board feel. The minimized contact area with the board efficiently channels power towards the edges, while the rockered corners of the baseplate allow any type of board to maintain optimal flex.

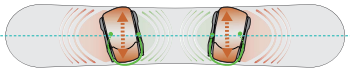

- ROCKERED CORNERS**
The rockered corners on the Axis-Series are designed with more cushioning on corners closer to the center-axis of the snowboard. This helps the board maintain a better and more natural flex.
- OFFSET MULTI-DISKS**
All adult and youth bindings feature our Multi-disk. So right out of the box, these bindings can be mounted on 4x4, 4x2, 2x4 and the NS Channel without the need for an accessory channel-disk. The hole patterns are offset from the center of the disk, for more toe-heel or stance-width adjustability.
- OFF-AXIS POWERBEAMS**
Off-Axis PowerBeams on the Axis-Series align more towards the toe and heel edges of the snowboard, if the binding is mounted on an angle on the board, for more efficient power/energy transfer. This accommodates more effortless and more powerful riding.
- OFFSET CABLE-ATTACHMENTS**
The PowerFrame cable on the Axis-Series is fastened onto the baseplate asymmetrically, on the end-points meet up closer to the middle-axis of the snowboard when the bindings are mounted on an angle. This helps with more evenly power transfer and a more balanced feel.
- BANKBEDS**
BankBeds are full-length EVA footbeds with 2-SP carving for optimized fit, support and energy transfer. Some models offer additional IV Gel cushioning, which helps absorb chatter and dampens landings.

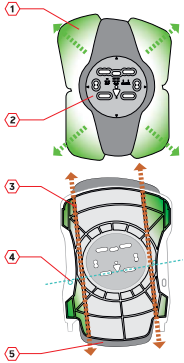

NS2-SERIES

The NS2-Series is a lightweight Aluminum-alloy rockered baseplate. This is our offset and most responsive baseplate, for riders who want immediate response and direct edge control.



FUSE-SERIES

The FUSE-Series is a Glass-filled Nylon rockered baseplate with Aluminum-alloy adjustable sideplates. This is a slightly softer baseplate compared to the NS2, but still very fun, direct and responsive, for riders that prefer the feel of a molded baseplate.



AXIS-SERIES

The AXIS-Series is a Glass-filled Nylon rockered baseplate with an asymmetrical design for optimal energy transfer. When than the NS2 and Fuse for stability and easy access, but with off-axis PowerBeams, asymmetrical roller-corners and offset cable attachments for a direct and balanced transfer of power to your board.

TECHNOLOGY



HIBACKS

Flow hbacks fully recline so you can get in and out of Flow bindings faster with no hassle or sitting down. The PowerTriangle cable efficiently transfers the energy from the hback and directs it into the baseplate. This allows Flow hbacks to be less cupped for more freedom of movement without loss of energy transfer compared to hbacks that do not benefit from the PowerTriangle energy-transfer through a cable.

MODBACK

The modular hbacks separate the lower and upper zones for targeted strength support and flex where you need it. The Aluminum alloy hback ModBacks offer more stiffness and response, while the Glass-filled Nylon ModBacks offer a bulky and fun feel. ModBacks also trigger the Active Strap Technology, and the upper zones use model-specific SupportPanels.

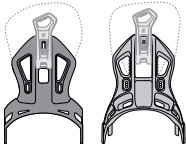

ASYM UNIBACK

Our asymmetrical 1-piece Unibacks are lightweight Glass-filled Nylon hbacks. They deliver a balance of support and comfort, with a perfect fit to follow the boot contour and curved riding angles. The AXXIS-Series Asym Uniback has a supportive shape with a more forgiving lateral flex, while the Fuso-series Asym Uniback has a wider range of support for more drive.



SUPPORT PANELS

The SupportPanels on our Modular Hbacks can be adjusted to a custom position, in both an up/down movement as well as a side-ways movement. This allows for slightly more or less heel-side support, and rotation to align with your snowboard edge or increased lateral/medial drive, based on your personal preference. Model-specific panels have unique flexes and asymmetrical shapes to ergonomically fit your body and deliver fine-tuned performance.



EVO-C9

The EVO-C9 SupportPanel is our most supportive and stiffest panel, with a wide shape and extended lateral curve for more drive into turns. Made with Glass-filled Nylon and a Carbon inlay, this panel delivers ultimate response.



ATN.8

This All-terrain panel is Glass-filled Nylon molded as well, and shaped slightly flatter and more narrow. This offers a perfect balance of stiffness and support with lateral flexibility for freedom of movement.



ARCK.6

The ARCK.6 shape is a blend between the EVO and ATN panels, slightly wider than the ATN but not as cupped as the EVO. Molded in a slightly softer Nylon composite, this panel offers plenty of support with a fun mix of playfulness.



POWERSTRAPS

Flow PowerStraps are 3D-shaped footstraps that cover a larger area of your foot, especially over the critical mid-foot area, connecting the ankle and toe straps. The result is more control over your snowboard and better energy transfer into your turns. There is no need to overtighten these straps, which helps you maintain better blood circulation, while avoiding pressure points and cold, cramped feet!

Whether they be our traditional, hand-stitched PowerStraps with molded 3D EVA cores for our GT-Series, our new EVO-Power2Straps with Dual-Layer technology, or our ComfortFit straps with foam cores, all of our straps are designed to deliver the benefits of the original Flow PowerStrap technology.



FUSION POWERSTRAP

Fusion one-piece PowerStraps are 3D-shaped for a great fit, and cover a larger area of your foot for more comfort and control. Best: Easy Entry and Set-it and Forget-it performance.



HYBRID POWERSTRAP

Hybrid PowerStraps connect the ankle strap to a more conventional toe strap, for the perfect mix of control and flexibility. Easy Entry with more of an ankle and toe strap feel.

EXO-POWERSTRAPS

These new EXO-PowerStraps feature a top layer of ExoSpines that form a direct connection with the binding over the ankle and toe areas to hold your boot firmly in place for optimum energy transfer. Underneath the ExoSpines, you have a choice of two types of main straps - ExoFrame or ExoKush- to form the second layer that hugs your boots and dissipates any unwanted pressure or energy, delivering a comfortable yet precise feeling.



EXO-FRAME POWERSTRAP

The upper layer of two ExoSpines over the ankle and toe zones with the lightweight, injected ExoFrame strap frame suspended underneath work together to distribute pressure evenly and focus energy into the baseplate.

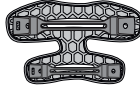

EXO-KUSH POWERSTRAP

The expanded EVA bottom layer of the Fusion ExoKush strap provides a perfect combination of control and lightness as it locks together with the two ExoSpines for uncompromised performance and comfort.



HYBRID EXO-FRAME + EXO-KUSH

Redesigned hybrid straps also benefit from a Dual-Layer design with a new upper layer Hybrid ExoSpine and new ankle-zone ExoFrame or ExoKush under layers.



HEMO TOECAP STRAP

The Hemo ToeCap strap features AuxTechs, a 3D biogrid Auxetic pattern for unmatched formfitting the toebox of your boot.

AUXTECH

BUCKLES

All Flow buckles lock 2-ways, so the footstrap can easily stay in the position you customized to fit your boots comfortably. Set-it and Forget-it, a truly hassle-free SpeedEntry experience, while also being able to get in & out like a 2-strap if you prefer.



LSR - LOCKING SLAP RATCHET

Locking Slap Ratchet (LSR) buckles give you the option to easily get in and out of your bindings any way you choose. Whether Set-it and Forget-it SpeedEntry, or side-entry like a 2-strap, they lock down to secure your preferred footstrap tightness.



QUICK-SET

Adjust your straps on the medial side to fit your boot and keep the footstrap centered. Easy and secure, the numbers on the ladder-straps help you conveniently dial in your setting.

TECHNOLOGY