

INNOVATIVE SIMPLISTIC PERFORMANCE

FIND YOUR FLOW

Flow is movement... continuity... zen. It's that blissful place where mind, body and spirit come together as one. We embody that moment and inspire our customers to embrace the freedom and joy of snowboarding, bringing a unique bindings system.

'96



MINIMUM
FRILLS,
MAXIMUM
PERFORMANCE



FLOW BINDINGS

RECLINING HIBACK

The Flow Reclining Hiback fully folds up and down, for the easiest way to get in & out of your bindings

DUAL-ENTRY

The universal interface and unrivaled versatility of our reclining hiback and full-sized LSR ratchets allow the ease of use and flexibility to choose how you want to enter & exit your bindings



ENERGY TRANSFER

The Power-Triangle creates a structural triangle between the hiback and baseplate for optimum energy transfer and making quick, easy and efficient turns

POWERSTRAP ACTIVATION

When you open the hiback, the PowerStrap is actively pushed out of the way, so you can easily and conveniently get your boot in and out of the binding. With the same ease, the PowerStrap footstrap hugs your boot at the consistent tightness you first set it at everytime you close the hiback

FLowsystem

THE MOST CONVENIENT PERFORMANCE DRIVEN BINDINGS

Flow bindings have stood the test of time. It all began with the original Reclining Hiback. Since then we've gone on to innovate in every aspect of snowboard binding design with features like our ActiveStrap technology, Reclining Hiback, PowerTriangle and Locking Slap Ratchets, as well as our latest innovation, EXO-PowerStraps. We're also excited to be introducing the new NX2-TM, Fuse-Carbon, Fenix-Plus and Mayon-Plus models for this season.



PERFECT FIT

FLOW 3D-shaped POWER-STRAPS cover a larger area of your foot and connect the ankle and toe areas, for a more convenient, comfortable and powerful riding experience

ON LOCK-DOWN

All Flow buckles lock down, so your footstraps will stay in the position customized to fit your boots comfortably. SET-IT and FORGET-IT; a truly hassle-free SpeedEntry experience

FLOW FIT

FlowFit guarantees the best fitting boots right out of the box with the perfect balance of comfort, support and control

EASY-IN EASY-OUT

The Speed-Entry Reclining Hiback folds fully up and down, making it the easiest way to get in and out of a pair of bindings

SPEED-ENTRY SYSTEM

EASY SET-IT AND FORGET-IT

Set-it and forget-it means always benefiting from the perfect and consistent tightness of your straps, and no hassling with ratchets in the snow. Flow PowerStraps are 3D-shaped and cover a larger surface of your foot. This results in more control over your snowboard and better energy transfer into your turns. There is no need to overly tighten these straps, so you maintain better blood circulation and avoid pressure points, cramping and cold feet!

EXO-KUSH POWERSTRAP

The expanded-EVA bottom layer of the Fusion ExoKush strap provides a perfect combination of comfort, control and lightness as it locks together with the two ExoSpines for uncompromised performance and comfort.

EXO-FRAME POWERSTRAP

A top layer of two ExoSpines over the ankle and toe zones, and an injected, lightweight Fusion strap frame suspended underneath work together to distribute the pressure evenly and focus energy into the baseplate.

HYBRID STRAPS
(EXO-FRAME AND EXO-KUSH)

Redesigned Hybrid straps also benefit from a dual-layer design with a new upper layer Hybrid ExoSpine and new ankle-zone ExoFrame or ExoKush under layers.

HEXO TOECAP STRAP

The Hexo Toecap strap features AuxTech; a 3D hinged Auxetic pattern for unmatched formfitting the toebox of your boot.

AUXTECH™

EXO-POWERSTRAPS

DUAL-LAYER DESIGN FOR PRECISE POWER DISTRIBUTION AND COMFORTABLE FIT

Our EXO-PowerStraps feature a top layer of ExoSpines that form a direct connection with the binding over the ankle and toe areas to hold your boot firmly in place for optimum energy transfer. Underneath the ExoSpines, you have a choice of two types of main straps -ExoFrame or ExoKush- to form the second layer that hugs your boots and dissipates any unwanted pressure or energy, delivering a comfortable yet precise feeling.

TECHNOLOGY

CORE-TECHNOLOGY AND ACTIVE STRAP TECHNOLOGY

These fundamental technologies make Flow bindings an industry leader. Active Strap Technology automatically lifts up the footstraps when you open the reclining hiback, and actively tightens them again to your personal position when you close the hiback. This reduces friction and creates more room for your boots, so that getting in & out of your bindings is faster and easier than ever.



ACTIVE STRAP TECH

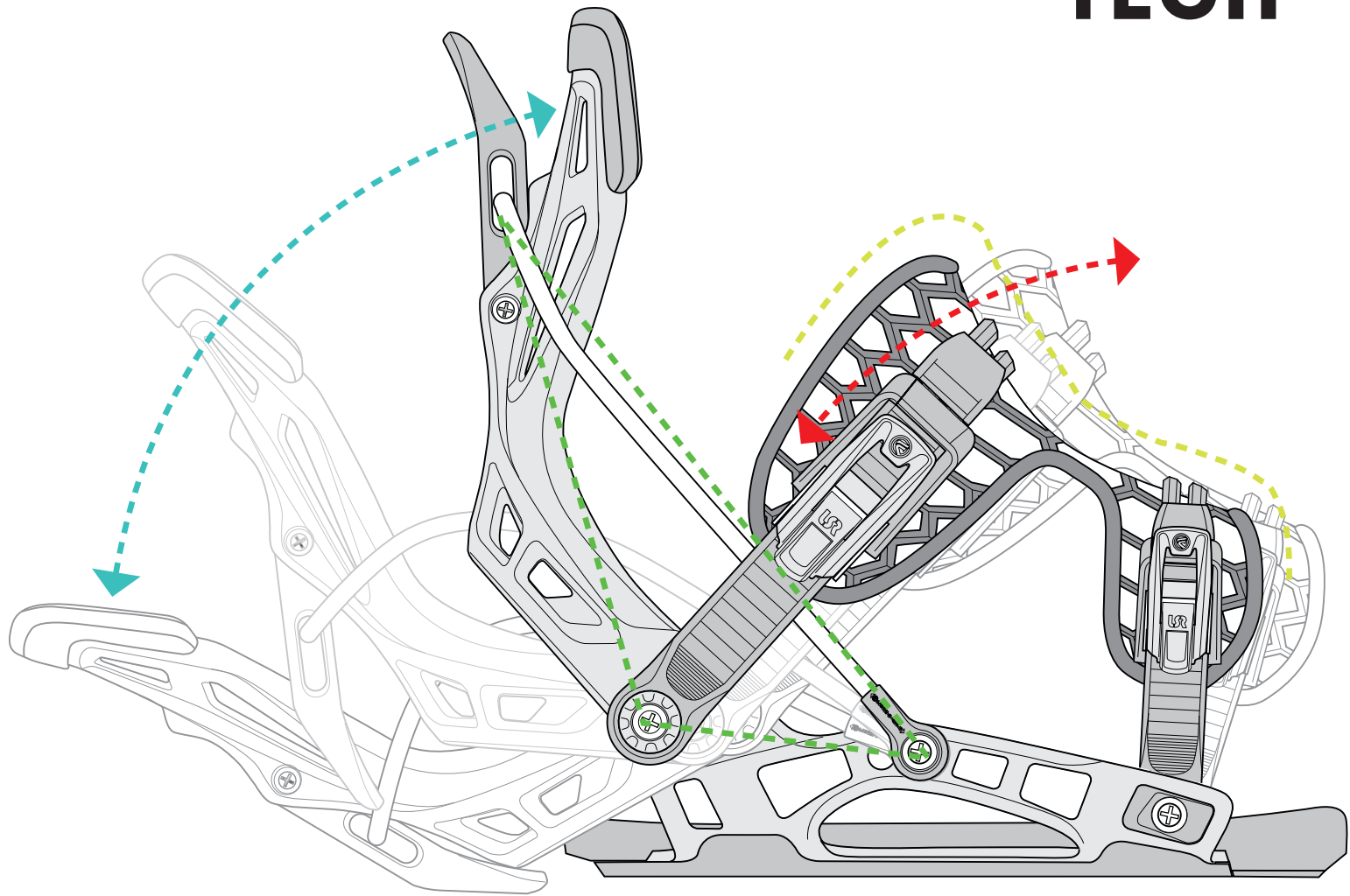

RECLINING HIBACK

The fully Reclining Hiback is a pivotal part for the fastest easy-in easy-out binding system. When you open the reclining hiback, a simple system actively lifts up the strap, and this same system tightens the strap automatically when you close the hiback.

POWER-TRIANGLE

The Flow high-tensile steel cable creates a structural triangle between the hiback and baseplate for optimum energy transfer and making quick, easy and efficient turns.

POWER-STRAPS

Flow PowerStraps are 3D-shaped and cover the critical mid-foot area, connecting the ankle and toe straps. The result is more control and better energy transfer. Also no need to overtighten, which benefits blood-circulation, and avoids pressure points and cold, cramped feet!

ACTIVE STRAP

When you open the hiback, the footstrap gets actively pushed out of the way, so you can easily and conveniently get your boot in and out of the binding. With the same ease, the Power-Strap footstrap hugs your boot at the consistent tightness you first set it at each time you close the hiback.

BASEPLATES

All of Flow's rockered baseplates are engineered to transfer energy directly to the board without loss of efficiency or natural board feel. The minimized contact area with the board efficiently channels power towards the edges, while the rockered corners of the baseplate allow any type of board to maintain optimal flex.

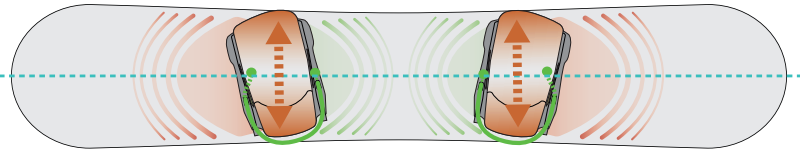

ROCKERED CORNERS

The rockered corners on the Axis-Series are designed with more cushioning on corners closer to the center-axis of the snowboard. This helps the board maintain a better and more natural flex.

OFFSET MULTI-DISKS

All adult and youth bindings feature our Multi-disk. So right out of the box, these bindings can be mounted on 4x4, 4x2, 3HP and the M6 Channel without the need for an accessory channel-disk. The hole-patterns are offset from the center of the disk, for more toe-heel or stance-width adjustability.

OFF-AXIS POWERBEAMS

Off-Axis PowerBeams on the Axis-Series align more towards the toe and heel edges of the snowboard, if the binding is mounted on an angle on the board, for more efficient power/energy transfer. This accommodates more effortless and more powerful riding.

OFFSET CABLE-ATTACHMENTS

The PowerTriangle cable on the Axis-Series is fixated onto the baseplate asymmetrically, so the end-points meet up closer to the middle-axis of the snowboard when the bindings are mounted on an angle. This helps with more evenly power transfer and a more balanced feel.

BANKBEDS

BankBeds are full-length EVA footbeds with 2.5° canting for optimized fit, support and energy transfer. Some models offer additional N-Gel cushioning, which helps absorb chatter and dampens landings.

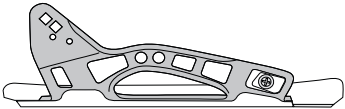
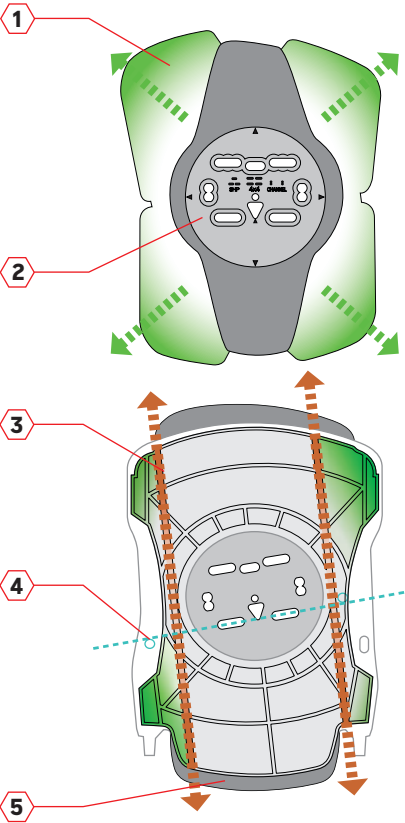

NX2-SERIES

The NX2-Series is a lightweight Aluminum-alloy rockered baseplate. This is our stiffest and most responsive baseplate, for riders who want immediate response and direct edge control.

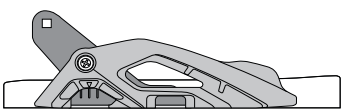

FUSE-SERIES

The FUSE-Series is a Glass-filled Nylon rockered baseplate, with Aluminum-alloy adjustable sidewings. This is a slightly softer baseplate compared to the NX2, but still very fun, direct and responsive, for riders that prefer the feel of a molded baseplate.

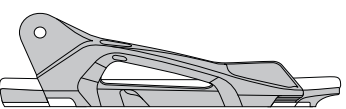

AXIS-SERIES

The AXIS-Series is a Glass-filled Nylon rockered baseplate with an asymmetrical design for optimal energy transfer. Wider than the NX2 and Fuse for stability and easy access, but with off-axis PowerBeams, asymmetrical rocker-corners and offset cable-attachments for a direct and balanced transfer of power to your board.

TECHNOLOGY

TECHNOLOGY

HIBACKS

Flow hibacks fully recline so you can get in and out of Flow bindings faster with no hassle or sitting down. The PowerTriangle cable efficiently transfers the energy from the hiback and directs it into the baseplate.

This allows Flow hibacks to be less cupped for more freedom of movement without loss of energy transfer compared to hibacks that do not benefit from the PowerTriangle energy-transfer through a cable.

MODBACK

The modular hiback separates the lower and upper zone for targeted strength, support and flex where you need it. The Glass-filled Nylon heelcup is medium-stiff for fast and playful riding, and triggers the ActiveStrap Technology.

The ATM.8 SupportPanel on the NX2 can be fully adjusted up&down as well as sideways for a custom height and rotation. Molded in Glass-filled Nylon and shaped slightly flatter and more narrow, it offers a perfect balance of stiffness and support with lateral flexibility for freedom of movement.

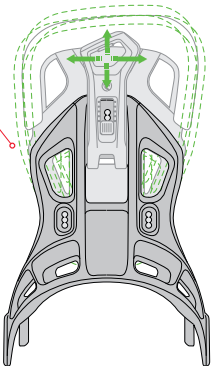

ASYM UNIBACK FUSE

The 1-piece Asymmetrical Fuse UniBack is a lightweight hiback shaped for a perfect fit with the boot contour and canted riding angles, and delivering a wider range of support for more drive.

Molded in our Glass-filled Nylon material on the Fuse, Omni and NX2-TM, they deliver a great balance of response and playfulness.

In the Carbon-Infused Nylon material as used on the Fuse-Carbon and NX2-CX, they offer increased rigidity to maximize power transfer and control.

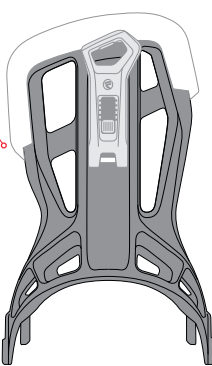

ASYM UNIBACK AXIS

The 1-piece Asymmetrical Axis UniBack is a medium-stiff Glass-filled Nylon hiback shaped for a perfect fit with the boot contour and canted riding angles, and has a supportive spine with a more forgiving lateral flex for a great mix of all-mountain and freestyle riding.

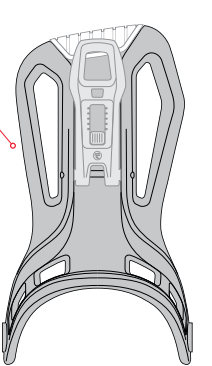

POWER-STRAP

Flow PowerStraps are 3D-shaped footstraps that cover a larger area of your foot, especially over the critical mid-foot area, connecting the ankle and toe straps. The result is more control over your snowboard and better energy transfer into your turns. There is no need to overtighten these straps, which helps you maintain better blood circulation, while avoiding pressure points and cold, cramped feet!

Whether they be our lightweight ExoFrame PowerStraps, our extra plush ExoKush PowerStraps, or our ComfortFit and UniFit straps with EVA-foam cores, all of our straps are designed to deliver the benefits of the original Flow PowerStrap technology.

FUSION POWERSTRAP

Fusion one-piece PowerStraps are 3D-shaped for a great fit, and cover a larger area of your foot for more comfort and control. Best Easy-Entry and Set-It and Forget-It performance.

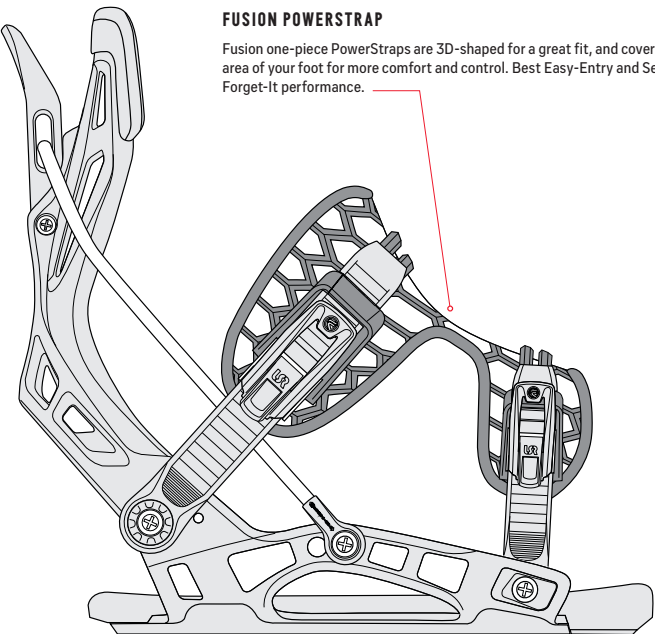

HYBRID POWERSTRAP

Hybrid PowerStraps connect the ankle strap to a more conventional toecap strap, for the perfect mix of control and flexibility. Easy-Entry with more of an ankle and toecap strap feel.

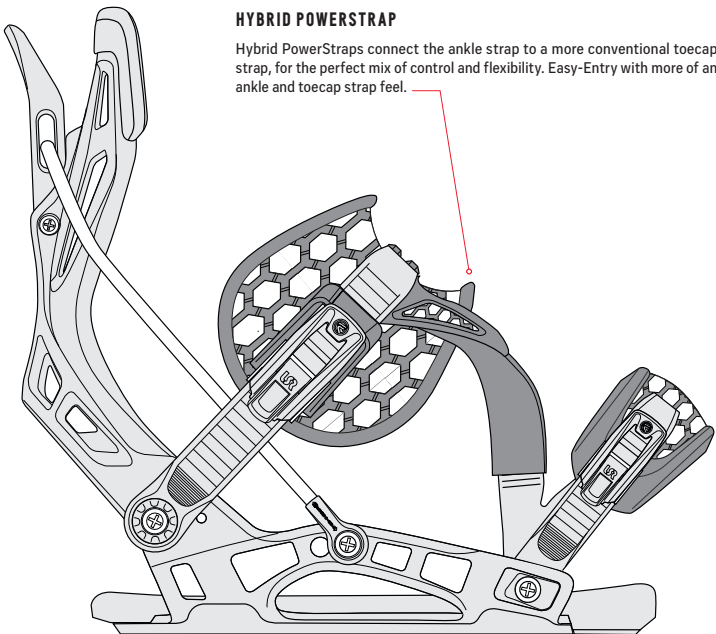

EXO-POWERSTRAPS

These new EXO-PowerStraps feature a top layer of ExoSpines that form a direct connection with the binding over the ankle and toe areas to hold your boot firmly in place for optimum energy transfer. Underneath the ExoSpines, you have a choice of two types of main straps -ExoFrame or ExoKush- to form the second layer that hugs your boots and dissipates any unwanted pressure or energy, delivering a comfortable yet precise feeling.



FUSION STRAPS

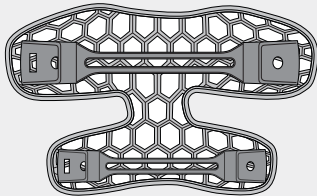

EXO-FRAME POWERSTRAP

The upper layer of two ExoSpines over the ankle and toe zones with the lightweight, injected Fusion strap frame suspended underneath work together to distribute pressure evenly and focus energy into the baseplate.

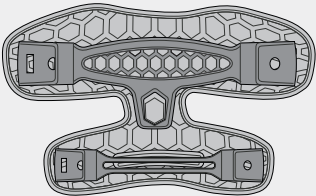

EXO-KUSH POWERSTRAP

The expanded-EVA bottom layer of the Fusion ExoKush strap provides a perfect combination of comfort, control and lightness as it locks together with the two ExoSpines for uncompromised performance and comfort.

HYBRID STRAPS

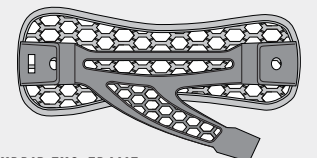

HYBRID EXO-FRAME

Suspended underneath the Hybrid Spine, the injected ankle-strap frame with Auxetic pattern delivers great form-fitting support.

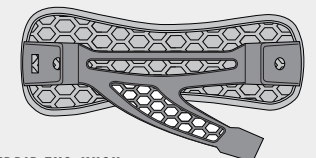

HYBRID EXO-KUSH

The Expanded-EVA ankle-strap of the Hybrid ExoKush provides a perfect combination of comfort, control and lightness.

HEXO TOECAP STRAP

The Hexo Toecap strap features AuxTech; a 3D hinged Auxetic pattern for next level connected comfort.

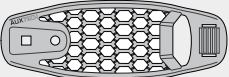

AUXTECH

BUCKLES



All Flow buckles lock 2-ways, so the footstrap can easily stay in the position you customized to fit your boots comfortably. Set-it and Forget-it, a truly hassle-free SpeedEntry experience, while also being able to get in & out like a 2-strap if you prefer.

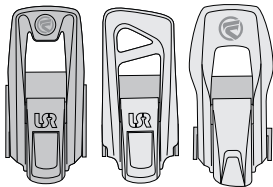

LSR - LOCKING SLAP RATCHET

Locking Slap Ratchet (LSR) buckles give you the option to easily get in and out of your bindings any way you choose. Whether Set-it and Forget-it SpeedEntry, or side-entry like a 2-strap, they lock down to secure your preferred footstrap tightness.

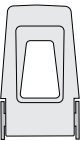

QUICK-SET

Adjust your straps on the medial side to fit your boot and keep the footstrap centered. Easy and secure, the numbers on the ladder-straps help you conveniently dial in your setting.